

# The MaxWell® Plus Drainage System Detail And Specifications

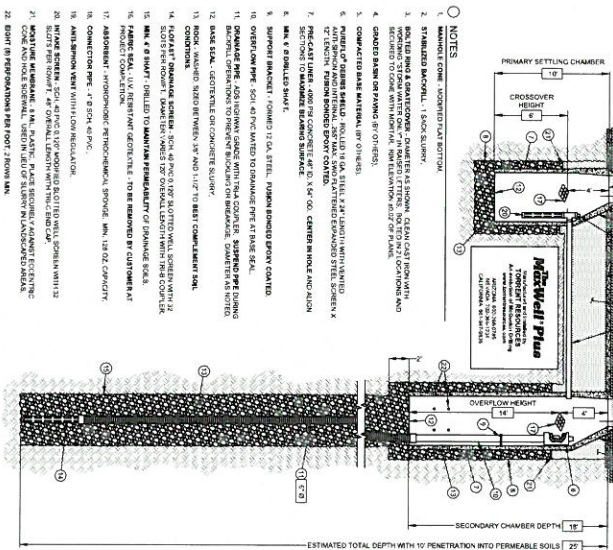

ESTIMATED TOTAL DEPTH WITH 10" PENETRATION INTO PERMEABLE SOILS

## PAVEMENT RENOVATION PLANS

FOR

**MARY MCLEOD  
BETHUNE SCHOOL**

1310 S. 16TH AVENUE, PHOENIX, AZ 85007

FOR

**PHOENIX ELEMENTARY SCHOOL DISTRICT NO. 1**  
1817 NORTH SEVENTH STREET  
PHOENIX, ARIZONA 85006  
PHONE: 602-257-3755

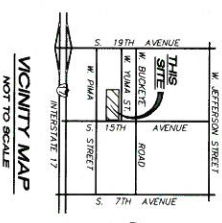

VICINITY MAP  
NOT TO SCALE

### ENGINEER

HESS-ROUNTREE, INC.  
9831 S 51ST STREET, SUITE C110  
PHOENIX, ARIZONA 85044  
PHONE: (480) 468-0944  
FAX: (480) 468-0944  
CONTACT: DOUG OSEBORN, P.E.

### OWNER

PHOENIX ELEMENTARY SCHOOL DISTRICT NO. 1  
1817 NORTH SEVENTH STREET  
PHOENIX, ARIZONA 85006  
PHONE: (602) 257-3755  
CONTACT: ANTHONY PARRA



**HESS - ROUNTREE, INC.**  
CONSULTING ENGINEERS & LAND SURVEYORS  
8831 SOUTH 51ST STREET, SUITE C110  
PHOENIX, ARIZONA 85044 (480) 468-0944

### DESIGN CIVIL ENGINEER'S NOTES TO CONTRACTOR:

- NOTHING CONTAINED IN THE CONTRACT DOCUMENTS SHALL CREATE, NOR SHALL BE CONSTRUED TO CREATE, ANY CONTRACTUAL OBLIGATION OR ANY SUBCONTRACTOR.
- THE DESIGN CIVIL ENGINEER WILL NOT BE RESPONSIBLE FOR CONSTRUCTION MEANS, METHODS, TECHNIQUES, SEQUENCES OR SCHEDULES. THE CONTRACTOR SHALL BE RESPONSIBLE FOR THE NECESSARY TO INSURE THAT ALL WORKMAN AND ON SITE PERSONNEL ARE TRAINED AND MAINTAINED IN A CLEAN, SAFE AND DIRT-FREE CONDITION AT ALL TIMES.
- THE CONTRACTOR SHALL PROVIDE ADEQUATE MEANS OF CLOSING TRUCKS AND/OR OTHER EQUIPMENT OF MUD PRIOR TO ENTERING PUBLIC STREETS. AND IT IS THE CONTRACTOR'S RESPONSIBILITY TO MAINTAIN THE CLOSURES AT ALL TIMES. THE CONTRACTOR SHALL BE RESPONSIBLE FOR THE NECESSARY TO INSURE THAT ALL WORKMAN AND ON SITE PERSONNEL ARE TRAINED AND MAINTAINED IN A CLEAN, SAFE AND DIRT-FREE CONDITION AT ALL TIMES.
- IT SHALL BE THE CONTRACTOR'S RESPONSIBILITY TO CONTACT THE BLUE STAKE CENTER TWO WORKING DAYS PRIOR TO ANY EXCAVATION.
- THE DESIGN CIVIL ENGINEER MAKES NO REPRESENTATION OR GUARANTEE REGARDING THE EXISTING CONDITIONS OR THAT THE EXISTING CONDITIONS WILL REMAIN UNCHANGED DURING THE CONSTRUCTION. THE CONTRACTOR SHALL BE RESPONSIBLE FOR THE NECESSARY TO INSURE THAT ALL WORKMAN AND ON SITE PERSONNEL ARE TRAINED AND MAINTAINED IN A CLEAN, SAFE AND DIRT-FREE CONDITION AT ALL TIMES.
- THE CONTRACTOR SHALL MAINTAIN ALL SETTING AND NEW ELEVATIONS, ADJUST, FIT, IN THE CONSTRUCTION AREA TO FINISH GRADE FOR THE ETC. IN CONCRETE PAVEMENT AREAS SHALL BE GRADED FROM THE CONCRETE PAVEMENT WITH EXPANSION JOINTS.
- THE CONTRACTOR SHALL MAINTAIN NO CLAIMS AGAINST THE OWNER OR SUBCONTRACTOR. THE CONTRACTOR SHALL BE RESPONSIBLE FOR THE NECESSARY TO INSURE THAT ALL WORKMAN AND ON SITE PERSONNEL ARE TRAINED AND MAINTAINED IN A CLEAN, SAFE AND DIRT-FREE CONDITION AT ALL TIMES.

### PROPOSED BASE BID QUANTITIES

- REMOVE AND REPLACE 3" THICK A.C. PAVEMENT 1,042 SY
- REMOVE AND REPLACE 2" THICK A.C. PAVEMENT 963 SY
- SEAL COAT 4,400 SY
- CURB REMOVAL AND REPLACEMENT 88 LF
- MASONRY CURB REMOVAL AND REPLACEMENT WITH SINGLE CURB 16 LF
- CONCRETE SIDEWALK REMOVAL AND REPLACEMENT 52 SF
- PIPE BOLLARD (MAG S.D. NO. 140) 1 EA
- GATE LOOPS FOR AUTOMATIC GATES 4 EA

### PROPOSED ALTERNATE NO. 1 QUANTITIES:

- SUBGRADE STABILIZATION 75 SY

### PROPOSED ALTERNATE NO. 2 QUANTITIES:

- DUAL CHAMBER DRYWELL 1 EA

### NOTE

CONTRACTOR SHALL VERIFY ALL QUANTITIES FOR BID PURPOSES.

### NOTE

THESE DRAWINGS ARE AN INSTRUMENT OF SERVICE ONLY AND ARE NOT TO BE REPRODUCED OR COPIED IN ANY MANNER WITHOUT THE WRITTEN PERMISSION OF HESS-ROUNTREE, INC. NO REPRODUCTION OR OTHER USE SHALL BE MADE BY ANY PERSON OR FIRM OTHER THAN HESS-ROUNTREE, INC. OR CITY OF PHOENIX WITHOUT EXPRESS WRITTEN PERMISSION OF HESS-ROUNTREE, INC. ANY UNAUTHORIZED USE SHALL VOID THE ENGINEER'S SEAL AND SIGNATURE HEREON AND NO PROFESSIONAL RESPONSIBILITY WILL REMAIN.



**PHOENIX ELEMENTARY SCHOOL DISTRICT NO. 1**  
PAVEMENT RENOVATION PLAN FOR  
MARY MCLEOD BETHUNE ELEMENTARY SCHOOL

DRAWING STATUS	SHEET	OF
BID DOCUMENTS	1	2
DATE	09-30-80	C-1



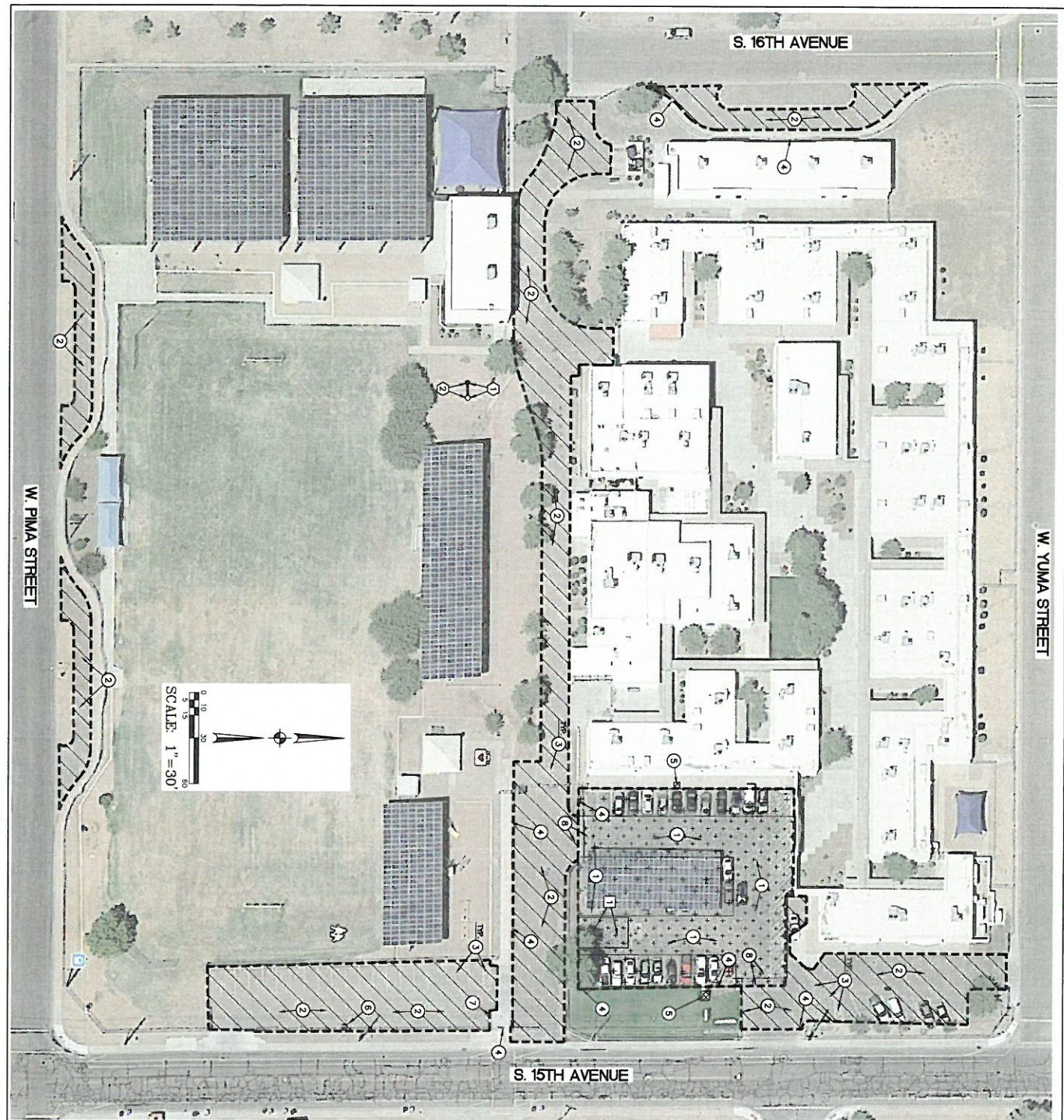

W. YUMA STREET

S. 16TH AVENUE

S. 15TH AVENUE

W. PIMA STREET

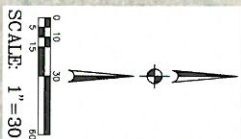

HESS - ROUNTREE, INC.  
CONSULTING ENGINEERS & LAND SURVEYORS  
1001 SOUTH STATE STREET, SUITE 210  
PHOENIX, ARIZONA 85004 (602) 944-5044

DATE: 09-30-80

# CONSTRUCTION NOTES:

1. SANIT AND EXISTING ASPHALT REMOVE EXISTING A.C. AS NEEDED TO INSTALL 3" OBTAIN THE SAME FINISH GRADE AS EXISTING MOISTURE CONDITION AND COMPACT A.B.C. TO ATTAIN 100% COMPACTION. PROOF ROLL A.B.C. TO CHECK FOR ANY SOFT SPOTS.
2. CLEAN AND FILL CRACKS IN EXISTING A.C. PAVEMENT. CLEAN PAVEMENT AND APPLY TWO COATS OF SEAL COAT TO EXISTING A.C. PAVEMENT.
3. EXISTING PARKING LOTS, DRIVEWAYS AND DRIVE OFF AREAS TO MATCH THE EXISTING STRIPES, ETC. WHICH ARE ON THE EXISTING PAVEMENT.
4. SANIT REMOVE AND REPLACE EXISTING CONCRETE CURB THAT IS BROKEN/CRACKED TO THE NEAREST JOINT.
5. SANIT REMOVE AND REPLACE EXISTING SIDEWALK TO THE NEAREST JOINT (MAY STANDARD DETAIL NO. 230).
6. INSTALL NEW PIPE ROLLAND TO MATCH EXISTING COLOR AND SIZE (MAY STANDARD DETAIL NO. 140).
7. SANIT REMOVE EXISTING WASTING CURB AND INSTALL 6" SINGLE CURB. SANIT REMOVE AND REPLACE 2" MINIMUM OF EXISTING A.C. PAVEMENT AT NEW CURB (MAY SPECIFICATION SECTION 308 AND C.O.P. DETAIL NO. P1200 OR REPLACE IN R.N.O. WHICHEVER IS GREATER).
8. CONTRACTOR TO REPLACE THE EXISTING TWO GATE LOOPS FOR THE AUTOMATIC GATE.

## ALTERNATE NO. 1

1. STABILIZE SUBGRADE WITH 12" A.B.C. OVER BRASS GEOTEXTILE REINFORCEMENT (MAY 78.2.4, TYPE 2). OVER NON WOODEN GEOPAVING (MAY 78.2.2 CLASS A) DIRECTLY ON SUBGRADE. CONCRETE SHALL BE INCLUDED IN THE B.B.C. NO.

## ALTERNATE NO. 2

1. INSTALL NEW DUAL CHAMBER DRIVELL (SEE DETAIL ON SHEET C-1).
2. CONTRACTOR TO HIRE A UTILITY LOCATOR TO LOCATE EXISTING UTILITIES AROUND THE NEW DRIVELL PRIOR TO THE START OF CONSTRUCTION. NOTIFY THE DESIGN ENGINEER OF ANY CONFLICTS.

## NOTES

1. CONTRACTOR TO LOCATE ALL THE UTILITY TRENCHES AND COVER FOR ALL UTILITIES WITHIN THE PROPOSED WORK AREA TO GRADE FOR MAINT REQUIREMENTS.
2. CONTRACTOR TO REMOVE AND REPLACE ALL THE PRECAST SAFETY CURBS AFTER THE PAVEMENT TREATMENT. ANY DAMAGED BARRIER BLOCK SHALL BE REPLACED.
3. THE QUANTITIES PROVIDED ARE BASED OFF GOOGLE MAPS. CONTRACTOR SHALL VERIFY THE QUANTITIES PRIOR TO BIDDING.
4. CONTRACTOR SHALL OBTAIN ALL DUST CONTROL AND STORMWATER POLLUTION PLAN PERMITS REQUIRED BY MARICOPA COUNTY AND THE ARIZONA DEPARTMENT OF ENVIRONMENTAL QUALITY.
5. ALL EXISTING PAINT AND STRIPES ON CURBS SHALL BE REPAINTED. CLEAN AND PREPARE CURBS AS NEEDED FOR REPAINT.
6. CONTRACTOR TO CLEAN AND REPAINT ALL LANDSCAPE AT OPENINGS IN THE PARKING LOT TO HAVE POSITIVE DRAINAGE OUT OF THE PARKING LOT.
7. ALL EXISTING HANDICAP SWINGS SHALL BE REPAINTED PER ADA REQUIREMENTS.

## LEGEND:

- REMOVE AND REPLACE 3" THICK A.C. PAVEMENT IN DRIVE AREAS.
- REMOVE AND REPLACE 2" THICK A.C. PAVEMENT IN PARKING STALLS
- SEAL COAT
- REMOVE AND REPLACE CONCRETE SIDEWALK

PHOENIX ELEMENTARY SCHOOL DISTRICT NO. 1  
PAVEMENT RENOVATION PLAN FOR  
MARY McLEOD BETHUNE ELEMENTARY SCHOOL



DATE: 09-30-80